

Plunger valves are composed of a cylindrical brass body, a steel plunger with a conical valve and a thrust spring. Connected to vacuum, they are normally closed. They activate suction, thus creating vacuum, only when the plunger is in contact with the gripping surface. They are available in various versions, all suitable for our vacuum cups.

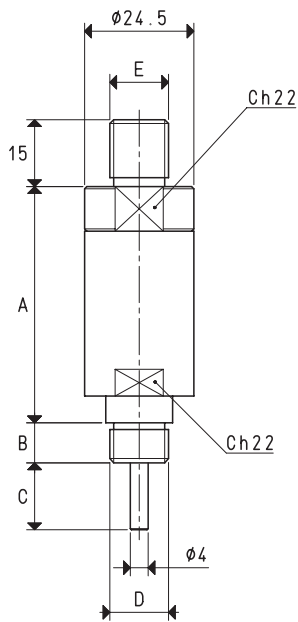

| Art.     | A  | B | C    | D<br>∅ | E<br>∅ | Weight<br>g | Cup<br>art. |
|----------|----|---|------|--------|--------|-------------|-------------|
| 19 01 10 | 53 | 9 | 15.0 | G1/4"  | G1/4"  | 160         | 08 150 16   |
| 19 01 11 | 53 | 9 | 15.0 | M12    | G1/4"  | 166         | 08 80 20    |
| 19 01 12 | 53 | 9 | 20.0 | M12    | G1/4"  | 152         | 08 127 15   |

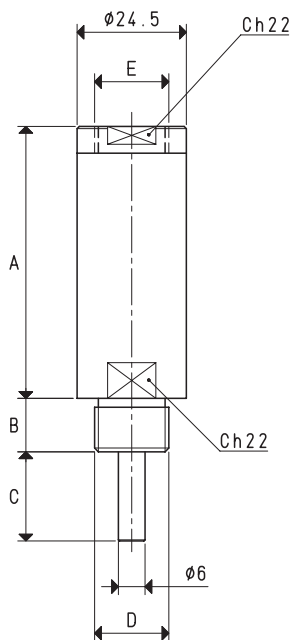

| Art.     | A  | B  | C    | D<br>∅ | E<br>∅ | Weight<br>g | Cup<br>art.                         |
|----------|----|----|------|--------|--------|-------------|-------------------------------------|
| 19 02 10 | 61 | 12 | 20   | G3/8"  | G3/8"  | 164         | 08 150 15<br>08 200 10              |
| 19 03 10 | 61 | 10 | 22,5 | G1/2"  | G3/8"  | 172         | 08 250 10<br>08 300 10<br>08 350 10 |
| 19 04 10 | 68 | 10 | 40   | G1/2"  | G3/8"  | 182         | 08 360 10                           |

Conversion ratio: inch =  $\frac{\text{mm}}{25.4}$ ; pounds =  $\frac{\text{g}}{453.6}$  =  $\frac{\text{Kg}}{0.4536}$

GAS-NPT thread adapters available at page 1.117