

Type ASA33

Type ASA33

Series of coils conforming to DIN 43650 standards.

They can be mounted on the following valves: AE..22, from 1/4" to 1".

For the connectors type A122... see page 2.210.20.

Voltage		Code	Item
12V	DC	034311	ASA3301200
12V	AC	034312	ASA3301250
24V	DC	034313	ASA3302400
24V	AC	034314	ASA3302450
48V	AC	034315	ASA3304850
110V	AC	034316	ASA3311050
230V	AC	034317	ASA3323050

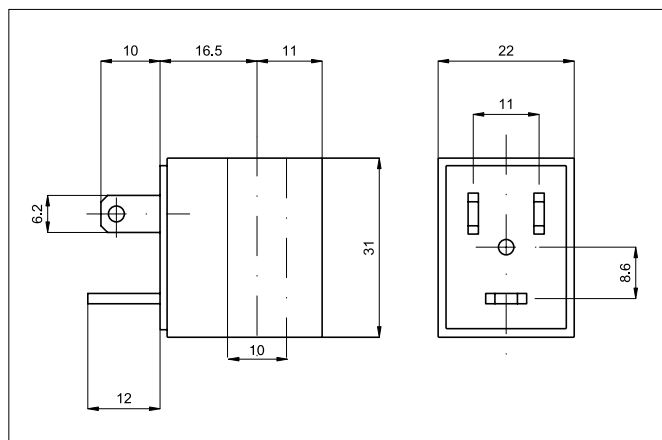
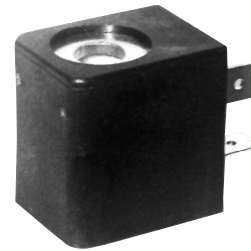

Technical data	Direct current	Alternating current
Voltage tolerance	± 10%	- 10% ÷ +15%
Frequency tolerance	-	± 5%
Electrical consumption	6,5 W	8 VA
Voltage	12 and 24 V	12, 24, 48, 110, 230 V 50/60HZ
Duty cycle	100% ED	
Class protection	IP 65 (with connector already mounted)	
Temperature range	-20 °C ÷ + 50 °C	
Response time	10 ms	

Type ASA32

Series of coils conforming to DIN 43650/A standards.

They can be mounted on the following valves: AE..22, 1 1/4", 1 1/2", 2".

For the connectors type A182... see page 2.210.30.

Voltage		Code	Item
12V	DC	034321	ASA3201200
12V	AC	034322	ASA3201250
24V	DC	034323	ASA3202400
24V	AC	034324	ASA3202450
48V	AC	034325	ASA3204850
110V	AC	034326	ASA3211050
230V	AC	034327	ASA3223050

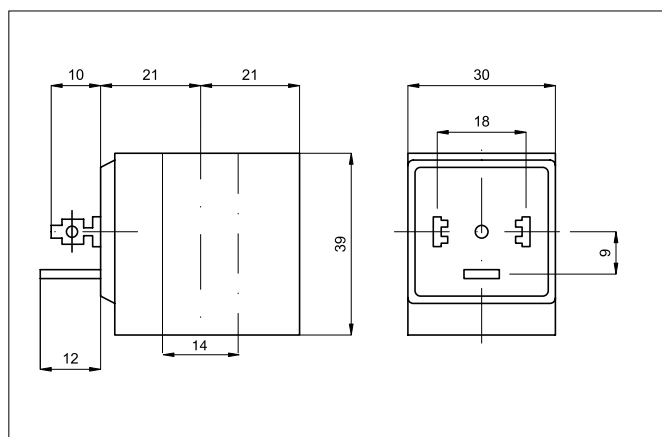

Technical data	Direct current	Alternating current
Voltage tolerance	± 10%	- 10% ÷ +15%
Frequency tolerance	-	± 5%
Electrical consumption	10 W	15 VA
Voltage	12 and 24 V	12, 24, 48, 110, 230 V 50/60HZ
Duty cycle	100% ED	
Class protection	IP 65 (with connector already mounted)	
Temperature range	-20 °C ÷ + 50 °C	
Response time	10 ms	