

2/2-Wege Coaxialventil 2/2-way coaxial valve

fremdgesteuert
Modulbauweise

externally controlled
modular design

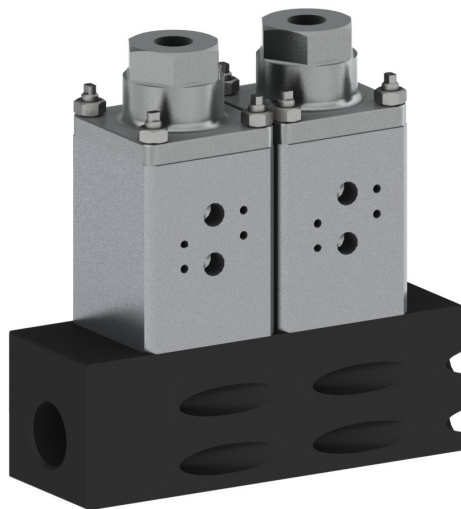

Schaltfunktion A: NC (stromlos geschlossen)
function A: NC (normally closed)

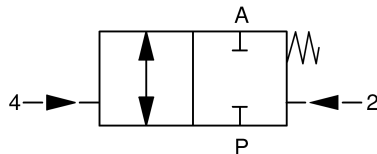

Baureihe 283-X Type 283-X

Schaltfunktion B: NO (stromlos offen)
function B: NO (normally open)

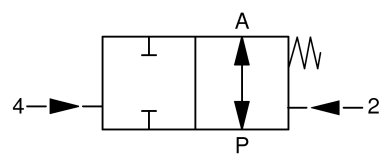

Nennweite	DN 15	diameter	DN 15
Druckbereich	0 – max. 200bar Gegendruckdicht bis max.16bar	pressure range	0 – max. 200bar backpressure leakproof up to max. 16bar
Gehäusewerkstoff	Einzelventil: Messing Block: Aluminium	body material	single valve: brass block: aluminium
Dichtwerkstoff	statisch: FKM dynamisch: PTFE Sitzdichtung: PTFE	seal material	static: FKM dynamic: PTFE seat seal: PTFE
Temperatur	Medium: -10 bis +100°C Umgebung: -10 bis +50°C	temperature	media: -10 up to +100°C ambient: -10 up to +50°C
Anschluss	Ventil: G3/8 – G3/4 Block: G1 1/4	connection	valve: G3/8 – G3/4 block: G1 1/4
Durchflußrichtung	P → A max. 200bar A → P max. 16bar	flow direction	P → A max. 200bar A → P max. 16bar
Antriebsteil	doppelt wirkender Kolben mit Rückstellfeder	actuating part	double acting piston with spring return
Steuerdruck	3 – 8bar Anschlüsse 2+4 (G1/4) Schnittstelle nach NAMUR	control pressure	3 – 8bar connections 2+4 (G1/4) port according to NAMUR
Schaltzeiten	eine vorgeschaltete Wartungseinheit verlängert die Lebensdauer der Ventile Öffnen / Schließen 50 – 1000ms Abhängig vom Steuerdruck, Pilotventil (Option) und Abluftdrosseln (Option)	switching time	an upstream service unit extends the lifetime of the valves opening / closing 50 – 1000ms depending on operating pressure, pilot valve (option) and exhaust air throttle (option)
Einbaulage	beliebig	mounting	in any position

2/2-Wege Coaxialventil 2/2-way coaxial valve

Baureihe 283-X Type 283-X

Baureihe type	DN [mm]	Druck pressure range [bar]	Anschluss connection	K _v -Wert flow rate [m ³ /h]	Gewicht - Messing weight - brass [kg]
283-X	15	0 – 200	G3/8, G1/2, G3/4	7,2	3,2

Schnittzeichnung sectional drawing

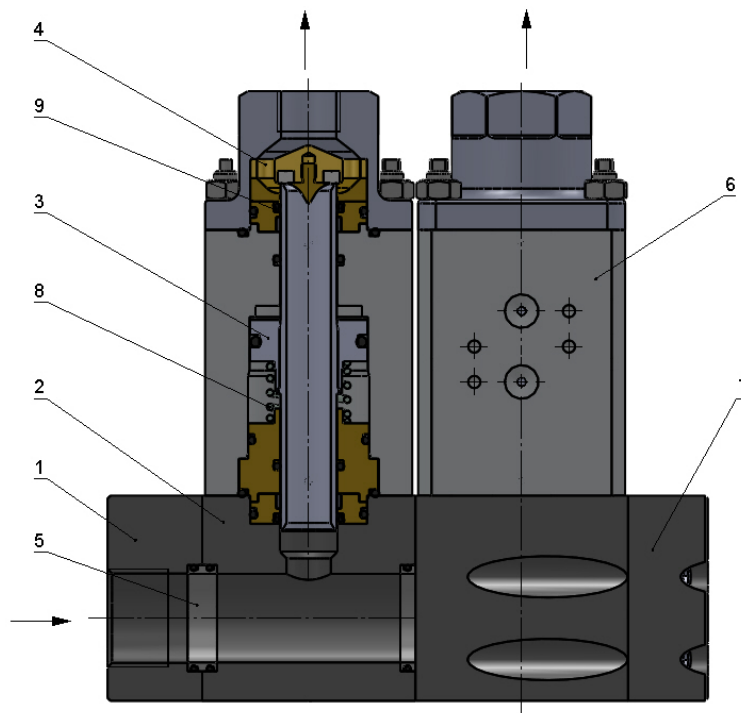

Pos. pos.	Menge quantity	Benennung	description
1	1	Anschlussstück links	fitting left
2	2	Blockmodul	block module
3	2	Kolben	piston
4	2	Ventilsitz	valve seat
5	3	Distanzstück	distance piece
6	2	Zylinder	cylinder
7	1	Abschlussdeckel	end cover
8	1	Feder	spring
9	2	PTFE-Stangendichtung	PTFE-rod seal

2/2-Wege Coaxialventil
2/2-way coaxial valve

Baureihe 283-X
Type 283-X

Maßzeichnung
dimension drawing

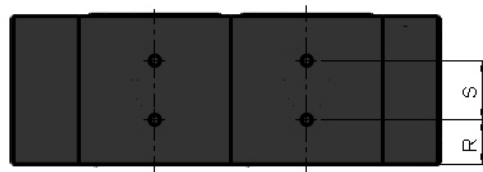

Steueranschluss G1/4
 control part G1/4

Anschlussbild nach NAMUR
 mounting face according
 to NAMUR

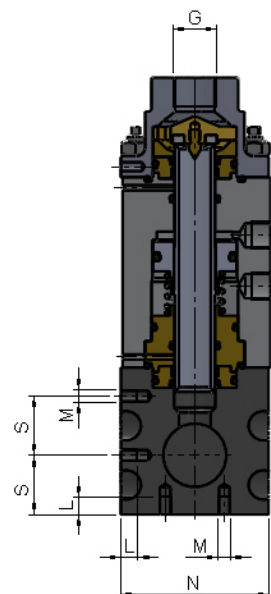
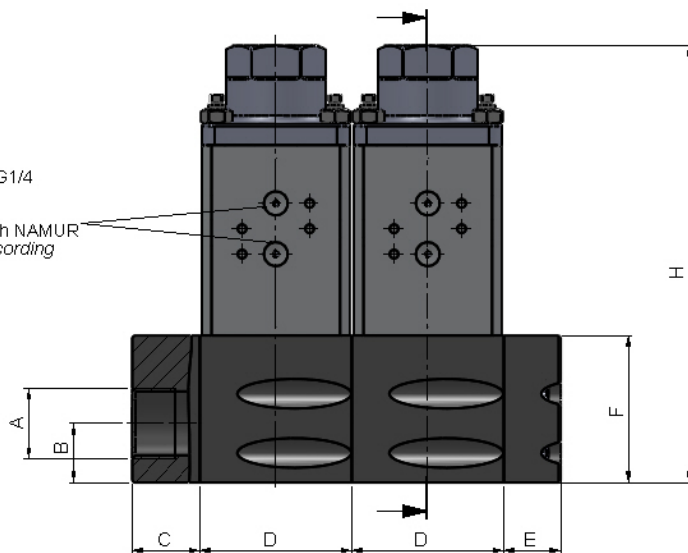



DN	A	B	C	D	E	F	H	G	L	M	R	S	N
[mm]		[mm]	[mm]	[mm]	[mm]	[mm]	[mm]		[mm]		[mm]	[mm]	[mm]
15	G1 1/4	28	32	72	27	69,5	207	3/8 - 1/2 - 3/4	8	M6	21	28	70

Typenschlüssel
type code

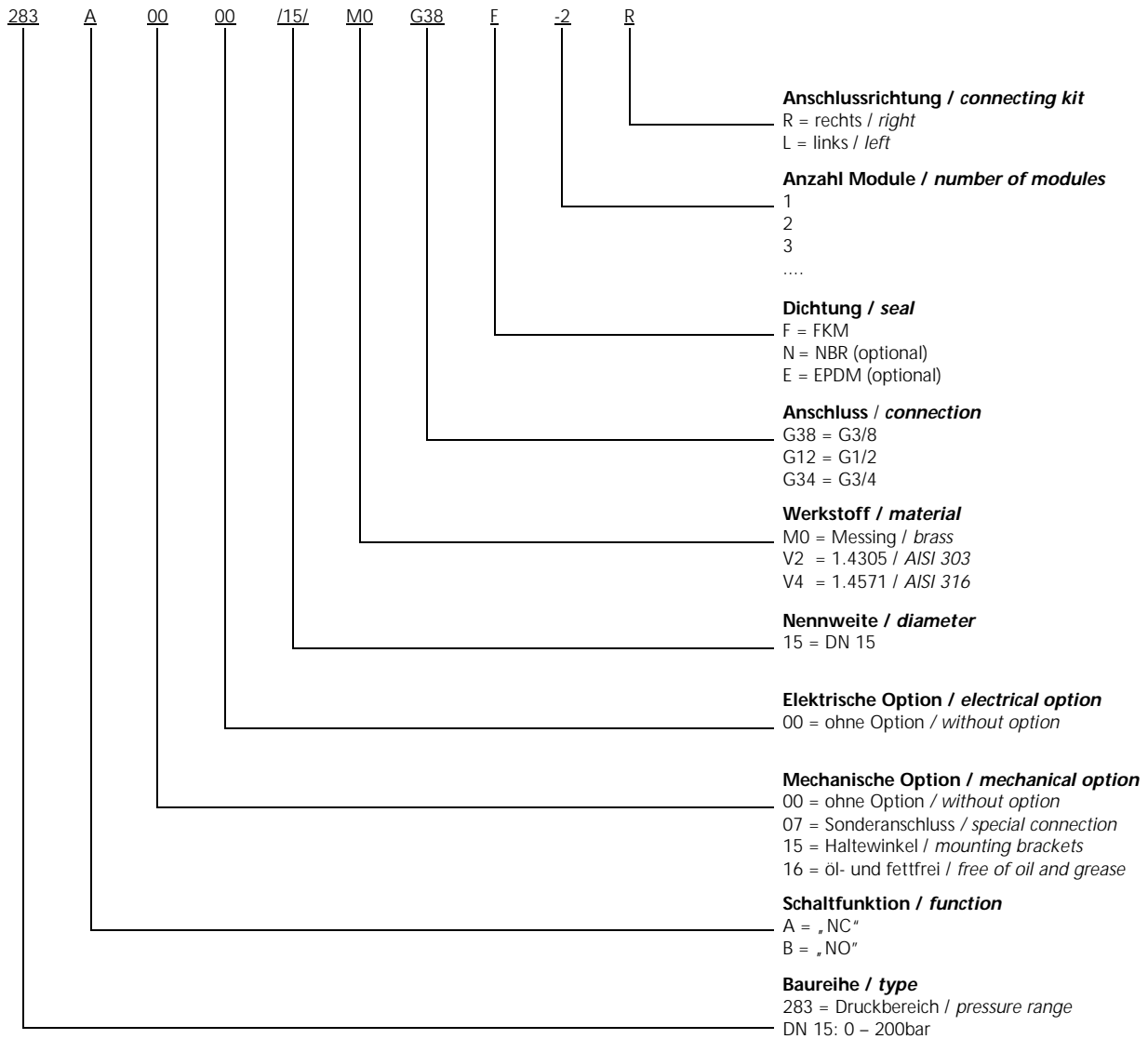
Die Typenbezeichnung setzt sich zusammen aus:
structure of the order specification:

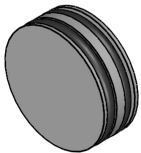
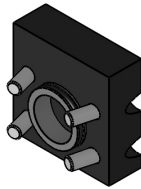

Zubehör
accessories

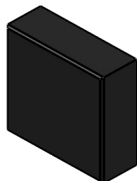

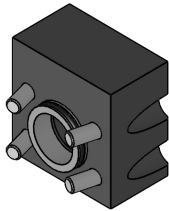
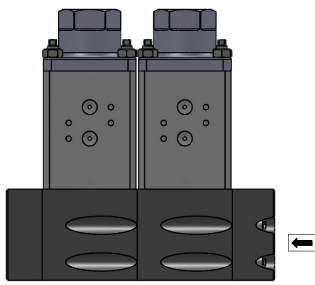
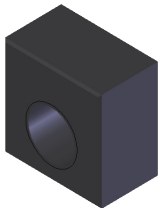
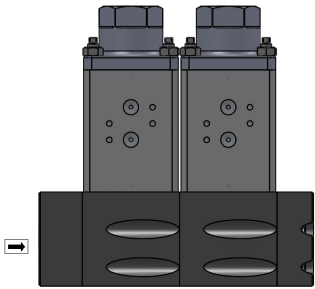
Verbindungsstücke <i>connecting pieces</i>		Abschlussstücke <i>end covers</i>	
	Trennscheibe <i>isolation disc</i>		Abschlussstück rechts <i>end cover right</i>
	Distanzstück <i>distance piece</i>		Abschlussstück links <i>end cover left</i>

Anschlusstücke <i>connection parts</i>		
	Anschlusstück rechts <i>connection part right</i>	
	Anschlusstück links <i>connection part left</i>	

2/2-Wege Coaxialventil
2/2-way coaxial valve

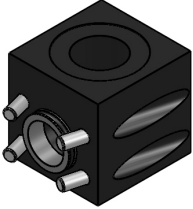
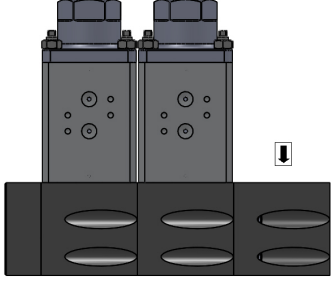
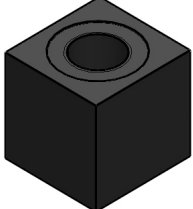
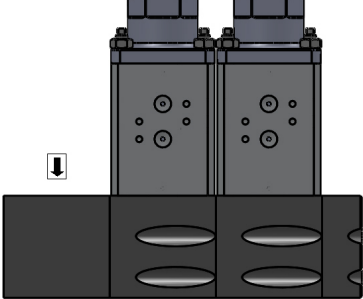

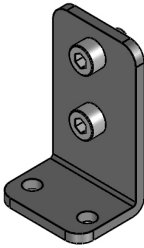
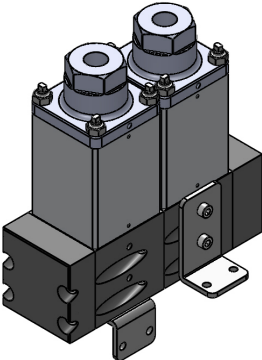
Baureihe 283-X
Type 283-X

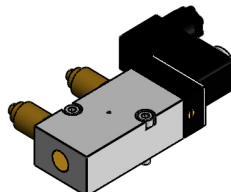
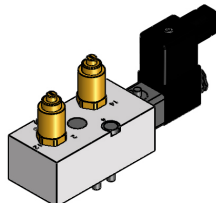
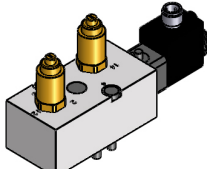
	<p>Anschlussstück rechts Eckausführung nach oben <i>connection part right 90°</i></p>	
	<p>Anschlussstück links Eckausführung nach oben <i>connection part left 90°</i></p>	

Weitere Optionen <i>further options</i>		
	<p>Haltewinkel <i>mounting brackets</i></p> <p>mechanische Option = 15 <i>mechanical option = 15</i></p>	
	<p>Abluftdrossel <i>exhaust air throttle</i></p> <p>G1/8 G1/4</p>	
	<p>Schalldämpfer Sinterbronze <i>silencer of sinter bronze casting</i></p> <p>G1/8 G1/4</p>	
	<p>5/2-Wege Pilotventil (NAMUR) zum Anflanschen Anschlüsse seitlich <i>5/2-way pilot valve (NAMUR) to flange connections laterally</i></p> <p>24V DC 230V 50Hz</p>	
	<p>5/2-Wege Pilotventil (NAMUR) zum Anflanschen Anschlüsse oben <i>5/2-way pilot valve (NAMUR) to flange connections above</i></p> <p>24V DC 230V 50Hz</p>	
	<p>5/2-Wege Pilotventil (NAMUR) zum Anflanschen Anschlüsse oben Magnet M12x1 <i>5/2-way pilot valve (NAMUR) to flange connections above solenoid M12 x 1</i></p> <p>24V DC 230V 50Hz</p>	

2/2-Wege Coaxialventil
2/2-way coaxial valve

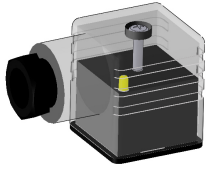
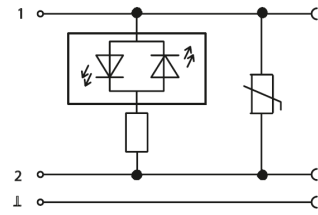
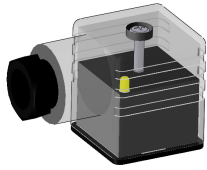
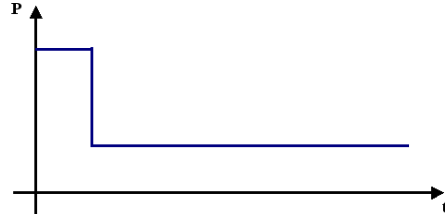
Baureihe 283-X
Type 283-X

	<p>Gerätesteckdose mit LED <i>plug with LED</i></p> <p>elektrische Option = 20 <i>electrical option = 20</i></p>	
	<p>Gerätesteckdose mit Leistungsabsenkung 24V DC Bauform A <i>plug with power reduction form A</i></p> <p>elektrische Option = 07 <i>electrical option = 07</i></p>	
	<p>Sonderschutzart <i>explosion proof</i></p> <p>II 2G Ex m II T4 II 3D IP65 T130°C</p> <p>elektrische Option = 13 <i>electrical option = 13</i></p>	

Weitere Optionen und Zubehör stimmen wir gerne auf Ihre Anforderungen ab.
We gladly coordinate further options and accessories according to your requirements.